

GENERATIONS



BY GATEWAY COMMUNITY CHURCH



GATEWAYMERCED.ORG/GENERATIONS

A WORD FROM PASTOR AL

I remember that first Sunday some years ago -

the first day of sign-ups for Summer Camp. Kids were excited, but our Children's pastors were having a hard time. I asked what was going on and learned that they'd already filled all available spots for camp that first day and now were trying to decide whom to turn away because there was no more room! And that was just the start, as more and more parents continued to call after that first day! It was - and is - both a good need and a bad problem...and a situation I cannot just ignore! When Jesus calls us to "go" to invite others into relationships with Him, but we can't even welcome those who are already trying to get in - then something must be done!!!

Friends, you and I can be the heroes who help welcome hundreds more kids each year to opportunities to get to know Jesus! Literally thousands & thousands more kids and their families can hear about Him over the next decades here at Gateway if we expand capacity to not only welcome those already knocking on our doors but also go beyond our current walls to help bring many more families to Jesus!

The following pages outline our plan to increase our welcoming capacity by 300% to be able to serve hundreds more kids and their parents and grandparents and neighbors year after year! For generations! Imagine! You can help us do that! We also want to add a bit of office space to host family seminars, life-impact groups like GriefShare, DivorceCare, etc, to heal and equip households, as well as give a better welcome to our community.

We hope you will prayerfully consider joining the group of heroes who will make it possible to reach so many more children and their families and neighbors for Jesus!



*GREAT IS THE LORD
AND MOST WORTHY
OF PRAISE; HIS
GREATNESS NO ONE
CAN FATHOM. ONE
GENERATION
COMMENDS YOUR
WORKS TO ANOTHER;
THEY TELL OF YOUR
MIGHTY ACTS.
PSALM 145: 3-4*

AL SCHAAP
SENIOR PASTOR



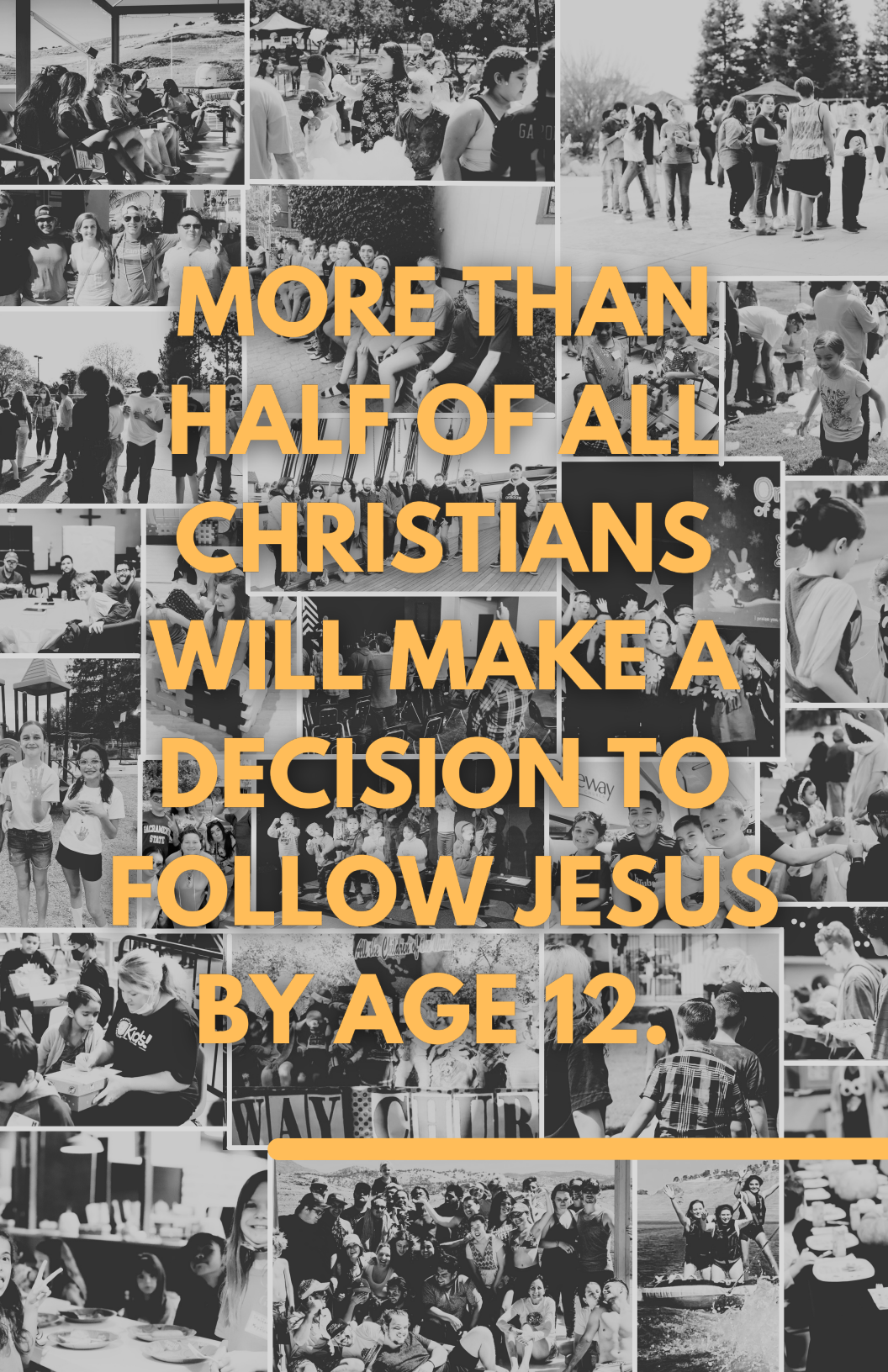

**MORE THAN
HALF OF ALL
CHRISTIANS
WILL MAKE A
DECISION TO
FOLLOW JESUS
BY AGE 12.**

THE PLAN

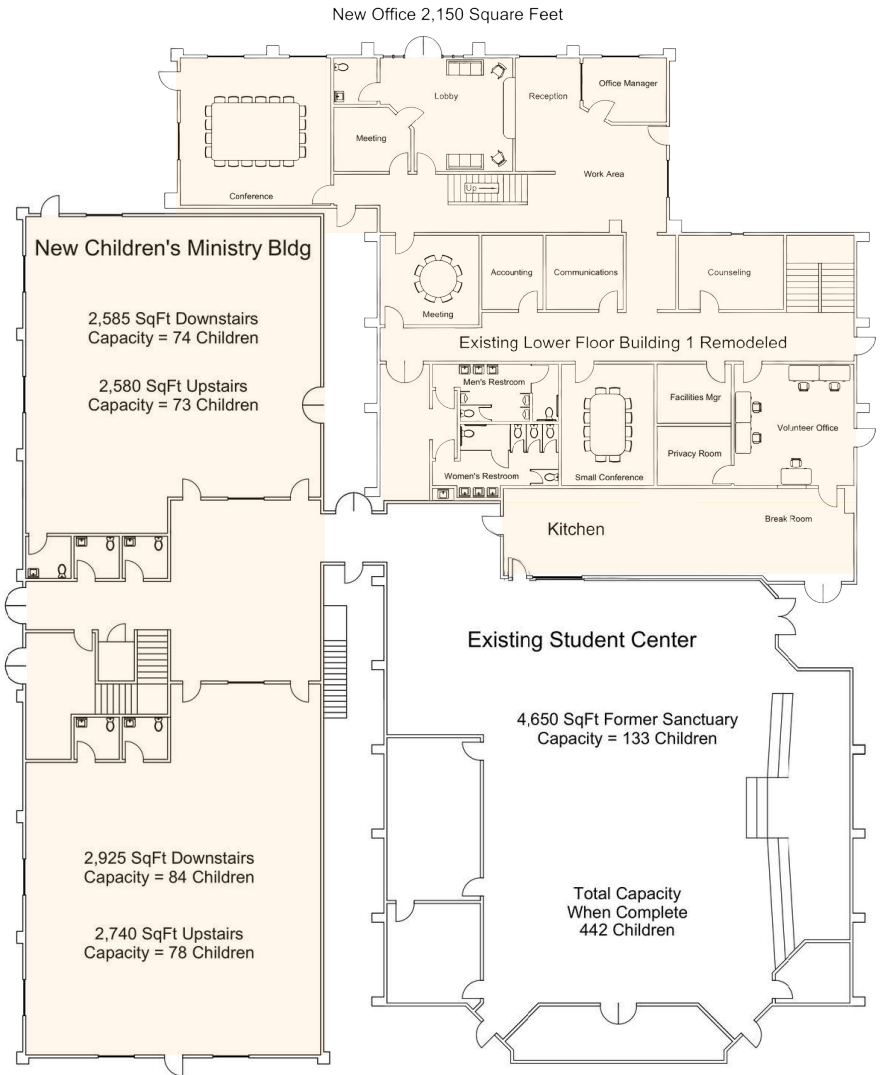

Quick Facts

- Adds 13,200 additional sq ft
 - ↳ Increasing capacity by 300%!
- Adds 2,150 sq ft to Office Building
 - ↳ Improving reception area, and comfort and safety for our staff
- Adds 2 bathrooms per children's classroom and includes family bathroom
 - ↳ Providing ease & comfort
- Triples capacity for EduCare After School Program
 - ↳ Allowing for more children to be admitted
- Triples capacity for Kid's Summer Camp
 - ↳ Allowing for more children to be admitted
- Triples capacity for general Children's ministry
 - ↳ Allowing for more ministries running concurrently
- Adds specifically designed area for children with special needs
 - ↳ Opening our ministries to largely unserved families
- Includes funding for renovating student & college spaces
 - ↳ Further developing and expanding the outreach for these ministries
- Renovates play areas for children
 - ↳ Increasing safety & attraction
- Includes large conference room for meetings, care groups, and family seminars.
 - ↳ Addressing new needs and training for parents as well as helping those going through seasons of special difficulty
- Includes solar for entire campus
 - ↳ Significantly reducing energy costs
- Funded without any loans
 - ↳ Desiring to be excellent stewards with no add to yearly financing needs

And I will make of you a great nation, and I will bless you and make your name great, so that you will be a blessing. I will bless those who bless you, and him who dishonors you I will curse, and in you all the families of the earth shall be blessed.”

Genesis 12: 2-3



300%

more children served on a weekly basis = 100s & 1000s
of kids hearing about Jesus!

35%

estimated savings by using in-house giftedness & volunteer labor

10%

of funds raised are to be paid forward to other ministries to
help them with their capital needs



LETTER FROM THE GATEWAY COUNCIL

Have you ever been without family? While most people may vary on specifics, we all want – and need – to belong!

The Gateway Church family has grown a lot since we started meeting at various schools and then the storefront on Main west of V. We have been blessed in many, many ways during these decades. Now some who were kids when we first opened the doors have kids of their own who are part of our Children's Ministries...and we pray that will continue for the decades and generations to come as we work with our faithful God!

But now we've grown to the place where we are turning children away year after year. That is not ok! Our programs are considered among the best in Merced; but a number of them are full, leaving parents and schools begging us for more space!

We also need more focused space to help equip parents, have good space for teens and college students, and bring God's healing to families.

All these things have led us to our plan to construct an additional building for Children's Ministries, enhance our office/reception and training space, and modify space for students. It's been a prolonged process to get the plans made – and then the pandemic put things into hibernation for quite some time. But now we are here and reigniting this effort. It is time to act!

We, as leaders of this part of God's church, are going first and are individually committing to give as we are able and prompted by God to do so. We are now asking you to consider investing in this great, heroic work with us as we invest for the children & families of our community. We look forward to serving alongside you in this project!

*In Christ's service,
The Elders and Deacons of Gateway*



GATEWAY COMMUNITY CHURCH



GATEWAYMERCED.ORG/GENERATIONS